



## TERMOTEC 316L

Il sistema TERMOTEC è composto da elementi a sezione circolare in parete doppia, con la parte interna realizzata in acciaio inox 316L e la parte esterna in acciaio inox 304 con finitura BA. Per diametri compresi tra 80 e 300: spessore di 25mm; per diametri di 350 e superiori: spessore di 50mm. Questi elementi sono dotati di innesto Maschio/Femmina a bicchiere, guarnizione di tenuta a triplo labbro fornita separatamente e nervatura per la fascetta di bloccaggio, disponibile su richiesta. Inoltre, l'intercapedine circolare è rivestita da lana di roccia ad alta densità. Le temperature massime di esercizio sono: 200°C con guarnizione e 600°C senza guarnizione.

**PDED-01 ELEMENTO DIRITTO MM. 945**

COD	DIAM	CONF	H	H1
PDED-01080	80/130		935	989
PDED-01100	100/150		935	989
PDED-01130	130/180		935	989
PDED-01150	150/200		935	989
PDED-01180	180/230		935	989
PDED-01200	200/250		935	989
PDED-01250	250/300		935	989
PDED-01300	300/350		935	989
PDED-01350	350/450		935	989
PDED-01400	400/500		935	989
PDED-01450	450/550		935	989
PDED-01500	500/600		935	989

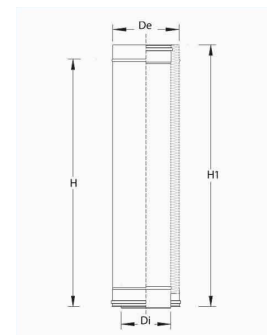

**PDED-02 ELEMENTO DIRITTO MM.435**

COD	DIAM	CONF	H	H1
PDED-02080	80/130		435	489
PDED-02100	100/150		435	489
PDED-02130	130/180		435	489
PDED-02150	150/200		435	489
PDED-02180	180/230		435	489
PDED-02200	200/250		435	489
PDED-02250	250/300		435	489
PDED-02300	300/350		435	489
PDED-02350	350/450		435	489
PDED-02400	400/500		435	489
PDED-02450	450/550		435	489
PDED-02500	500/600		435	489

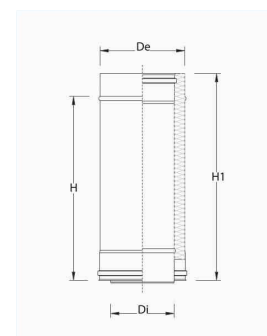

**PDED-03 ELEMENTO DIRITTO MM. 200**

COD	DIAM	CONF	H	H1
PDED-03080	80/130		200	250
PDED-03100	100/150		200	250
PDED-03130	130/180		200	250
PDED-03150	150/200		200	250
PDED-03180	180/230		200	250
PDED-03200	200/250		200	250
PDED-03250	250/300		200	250
PDED-03300	300/350		200	250
PDED-03350	350/450		200	250
PDED-03400	400/500		200	250
PDED-03450	450/550		200	250
PDED-03500	500/600		200	250

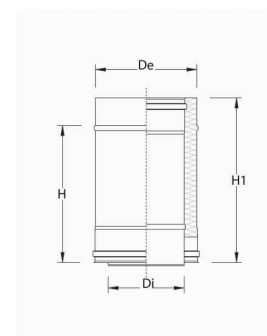

**PDET-04 ELEMENTO TELESCOPICO 265/392**

COD	DIAM	CONF	H min.	H max.
PDET-04080	80/130		265	392
PDET-04100	100/150		265	392
PDET-04130	130/180		265	392
PDET-04150	150/200		265	392
PDET-04180	180/230		265	392
PDET-04200	200/250		265	392
PDET-04250	250/300		265	392
PDET-04300	300/350		265	392
PDET-04350	350/450		265	392
PDET-04400	400/500		265	392
PDET-04450	450/550		265	392
PDET-04500	500/600		265	392

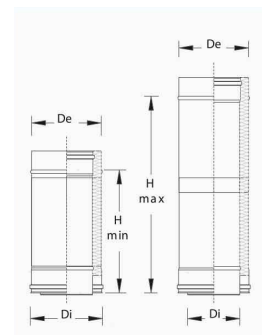

**PDET-11 ELEMENTO TELESCOPICO 350/560**

COD	DIAM	CONF	H min.	H max.
PDET-11080	80/130		350	560
PDET-11100	100/150		350	560
PDET-11130	130/180		350	560
PDET-11150	150/200		350	560
PDET-11180	180/230		350	560
PDET-11200	200/250		350	560
PDET-11250	250/300		350	560
PDET-11300	300/350		350	560
PDET-11350	350/450		350	560
PDET-11400	400/500		350	560
PDET-11450	450/550		350	560
PDET-11500	500/600		350	560

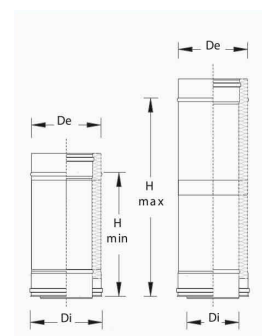

**PDET-05 ELEMENTO TELESCOPICO 501/878**

COD	DIAM	CONF	H min.	H max.
PDET-05080	80/130		501	878
PDET-05100	100/150		501	878
PDET-05130	130/180		501	878
PDET-05150	150/200		501	878
PDET-05180	180/230		501	878
PDET-05200	200/250		501	878
PDET-05250	250/300		501	878
PDET-05300	300/350		501	878
PDET-05350	350/450		501	878
PDET-05400	400/500		501	878
PDET-05450	450/550		501	878
PDET-05500	500/600		501	878

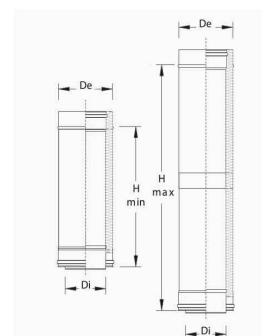

**PDRT-08 RACCORDO T 90°**

COD	DIAM	CONF	H	H1	A
PDRT-08080	80/130		273	158	140
PDRT-08100	100/150		273	250	150
PDRT-08130	130/180		440	250	165
PDRT-08150	150/200		440	250	175
PDRT-08180	180/230		440	250	190
PDRT-08200	200/250		440	250	200
PDRT-08250	250/300		440	250	225
PDRT-08300	300/350		485	265	250
PDRT-08350	350/450		585	315	300
PDRT-08400	400/500		635	340	325
PDRT-08450	450/550		685	365	350
PDRT-08500	500/600		735	390	375

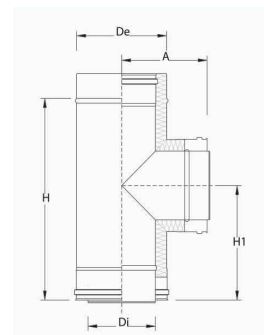

**PDTR-28 RACCORDO A T 90° RID. D.80**

COD	DIAM	CONF	H	H1	A
PDTR-28080	80/130		200	120	90
PDTR-28100	100/150		200	120	100
PDTR-28130	130/180		200	120	115
PDTR-28150	150/200		200	120	125
PDTR-28180	180/230		200	120	140
PDTR-28200	200/250		200	120	150
PDTR-28250	250/300		200	120	175
PDTR-28300	300/350		200	120	200
PDTR-28350	350/450		200	120	250
PDTR-28400	400/500		200	120	275
PDTR-28450	450/550		200	120	300
PDTR-28500	500/600		200	120	325

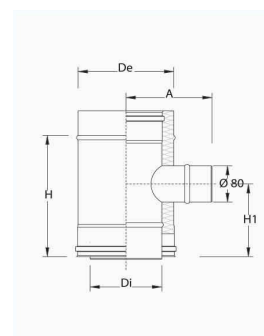

**PDRB-82 RACCORDO A T 135°**

COD	DIAM	CONF	H	A
PDRB-82080	80/130		423	228
PDRB-82100	100/150		458	248
PDRB-82130	130/180		498	270
PDRB-82150	150/200		526	288
PDRB-82180	180/230		564	312
PDRB-82200	200/250		592	330
PDRB-82250	250/300		664	372
PDRB-82300	300/350		738	416
PDRB-82350	350/450		880	500
PDRB-82400	400/500		952	544
PDRB-82450	450/550		1022	586
PDRB-82500	500/600		1092	628

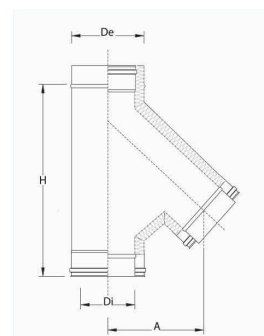

**PDCN-90 CURVA 90°**

COD	DIAM	CONF	A	H
PDCN-90080	80/130		100	160
PDCN-90100	100/150		120	180
PDCN-90130	130/180		130	190
PDCN-90150	150/200		140	200
PDCN-90180	180/230		155	215
PDCN-90200	200/250		165	220
PDCN-90250	250/300		190	250
PDCN-90300	300/350		215	275
PDCN-90350	350/450		260	320
PDCN-90400	400/500		330	385
PDCN-90450	450/550		355	405
PDCN-90500	500/600		380	430

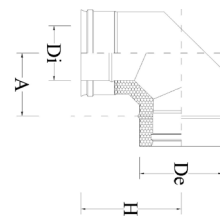

**PDCQ-45 CURVA 45°**

COD	DIAM	CONF	H	A
PDCQ-45080	80/130		119	67
PDCQ-45100	100/150		126	70
PDCQ-45130	130/180		141	75
PDCQ-45150	150/200		148	77
PDCQ-45180	180/230		159	83
PDCQ-45200	200/250		166	89
PDCQ-45250	250/300		184	92
PDCQ-45300	300/350		202	105
PDCQ-45350	350/450		237	118
PDCQ-45400	400/500		255	126
PDCQ-45450	450/550		272	133
PDCQ-45500	500/600		290	140

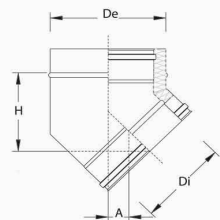

**PDCT-30 CURVA 30°**

COD	DIAM	CONF	H	A
PDCT-30080	80/130		126	45
PDCT-30100	100/150		129	47
PDCT-30130	130/180		137	48
PDCT-30150	150/200		142	50
PDCT-30180	180/230		149	52
PDCT-30200	200/250		154	53
PDCT-30250	250/300		167	56
PDCT-30300	300/350		179	59
PDCT-30350	350/450		204	66
PDCT-30400	400/500		217	69
PDCT-30450	450/550		229	73
PDCT-30500	500/600		242	76

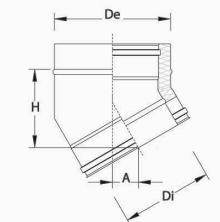

**PDCQ-15 CURVA 15°**

COD	DIAM	CONF	H	A
PDCQ-15080	80/130		120	23
PDCQ-15100	100/150		122	24
PDCQ-15130	130/180		127	24
PDCQ-15150	150/200		129	25
PDCQ-15180	180/230		135	26
PDCQ-15200	200/250		137	26
PDCQ-15250	250/300		139	27
PDCQ-15300	300/350		145	27
PDCQ-15350	350/450		160	29
PDCQ-15400	400/500		170	30
PDCQ-15450	450/550		175	30
PDCQ-15500	500/600		180	32

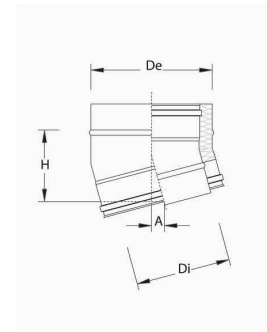

**PDRTI-07 RACCORDO A T90° CON ISPEZIONE**

COD	DIAM	CONF	H	H1	A
PDRTI-07080	80/130		273	158	140
PDRTI-07100	100/150		273	250	150
PDRTI-07130	130/180		440	250	165
PDRTI-07150	150/200		440	250	175
PDRTI-07180	180/230		440	250	190
PDRTI-07200	200/250		440	250	200
PDRTI-07250	250/300		440	250	225
PDRTI-07300	300/350		485	265	250

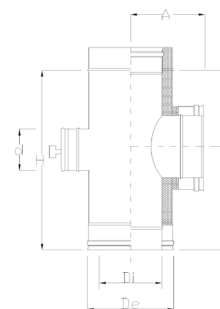

**PDMI-42 MODULO D' ISPEZIONE**

COD	DIAM	CONF	H	H1	A
PDMI-42080	80/130		268	160	42
PDMI-42100	100/150		268	160	42
PDMI-42130	130/180		435	249	42
PDMI-42150	150/200		435	249	42
PDMI-42180	180/230		435	249	42
PDMI-42200	200/250		435	249	42
PDMI-42250	250/300		435	249	42
PDMI-42300	300/350		435	249	42
PDMI-42350	350/450		435	249	42
PDMI-42400	400/500		435	249	42
PDMI-42450	450/550		435	249	42
PDMI-42500	500/600		435	249	42

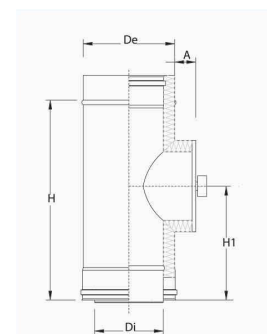

**PDMR-43 MODULO RILEVAMENTO FUMI E TEMPERATURA**

COD	DIAM	CONF	H
PDMR-43080	80/130		435
PDMR-43100	100/150		435
PDMR-43130	130/180		435
PDMR-43150	150/200		435
PDMR-43180	180/230		435
PDMR-43200	200/250		435
PDMR-43250	250/300		435
PDMR-43300	300/350		435
PDMR-43350	350/450		435
PDMR-43400	400/500		435
PDMR-43450	450/550		435
PDMR-43500	500/600		435

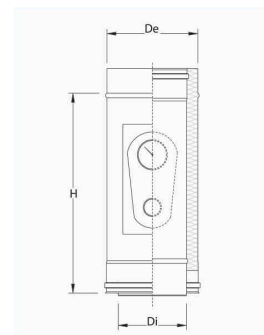

**PDMPF-41 MODULO RILEVAMENTO FUMI**

COD	DIAM	CONF	H	H1
PDMPF-41080	80/130		200	250
PDMPF-41100	100/150		200	250
PDMPF-41130	130/180		200	250
PDMPF-41150	150/200		200	250
PDMPF-41180	180/230		200	250
PDMPF-41200	200/250		200	250
PDMPF-41250	250/300		200	250
PDMPF-41300	300/350		200	250
PDMPF-41350	350/450		200	250
PDMPF-41400	400/500		200	250
PDMPF-41450	450/550		200	250
PDMPF-41500	500/600		200	250

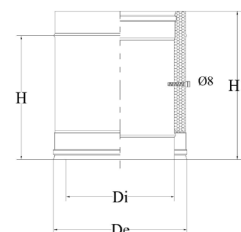

**PDTC-85 TAPPO SCARICO CONDENSA**

COD	DIAM	CONF	H
PDTC-85080	80/130		90
PDTC-85100	100/150		90
PDTC-85130	130/180		90
PDTC-85150	150/200		90
PDTC-85180	180/230		90
PDTC-85200	200/250		90
PDTC-85250	250/300		90
PDTC-85300	300/350		90
PDTC-85350	350/450		90
PDTC-85400	400/500		90
PDTC-85450	450/550		90
PDTC-85500	500/600		90

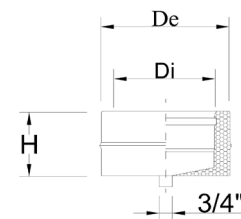

**PDCR-44 CAMERA RACCOLTA INCOMBUSTI**

COD	DIAM	CONF	H
PDCR-44080	80/130		435
PDCR-44100	100/150		435
PDCR-44130	130/180		435
PDCR-44150	150/200		435
PDCR-44180	180/230		435
PDCR-44200	200/250		435
PDCR-44250	250/300		435
PDCR-44300	300/350		435
PDCR-44350	350/450		435
PDCR-44400	400/500		435
PDCR-44450	450/550		435
PDCR-44500	500/600		435

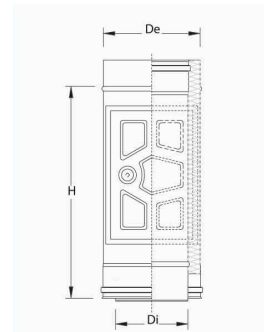

**PDEC-45 ELEMENTO DI COMPENSAZIONE**

COD	DIAM	CONF	H	H1
PDEC-45080	80/130		330	275
PDEC-45100	100/150		330	275
PDEC-45130	130/180		330	275
PDEC-45150	150/200		330	275
PDEC-45180	180/230		330	275
PDEC-45200	200/250		330	275
PDEC-45250	250/300		330	275
PDEC-45300	300/350		330	275

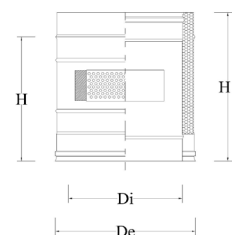

**PTII PASSAGGIO TETTO**

COD	DIAM	CONF	H	De
PTII080	80/130		940	230
PTII100	100/150		940	250
PTII130	130/180		940	300
PTII150	150/200		940	300
PTII180	180/230		940	350
PTII200	200/250		940	350
PTII250	250/300		940	400
PTII300	300/350		940	450

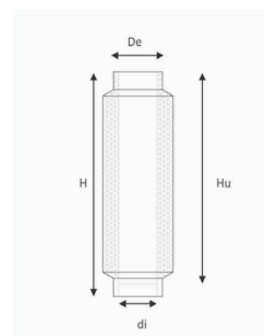

**PDPASS PASSAGGIO A TETTO PASSANTE**

COD	DNI	DNE	H	H1
PDPASS080	150	300	650	600
PDPASS100	170	300	650	600
PDPASS130	200	350	650	600
PDPASS150	220	350	650	600
PDPASS180	250	400	650	600
PDPASS200	270	400	650	600
PDPASS250	320	400	650	600
PDPASS300	370	500	650	600

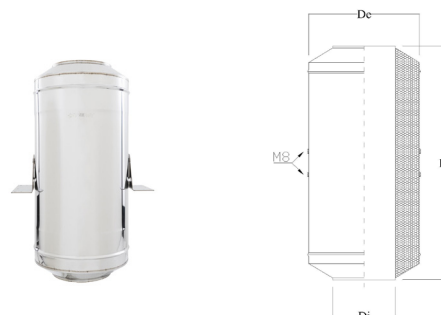

**PDMPFI-60 MODULO PRESA FUMI IND 1 ATT**

COD	DIAM	CONF	H	H1
PDMPFI-60080	80/130		200	250
PDMPFI-60100	100/150		200	250
PDMPFI-60130	130/180		200	250
PDMPFI-60150	150/200		200	250
PDMPFI-60180	180/230		200	250
PDMPFI-60200	200/250		200	250
PDMPFI-60250	250/300		200	250
PDMPFI-60300	300/350		200	250

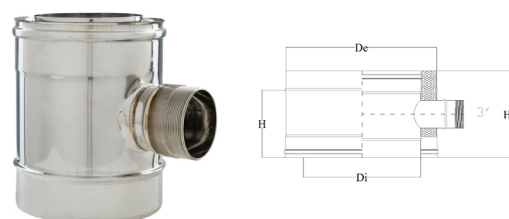

**PDMPFI2-60 MODULO PRESA FUMI IND 2 ATT**

COD	DIAM	CONF	H	H1
PDMPFI-60350	350/450		200	250
PDMPFI-60400	400/500		200	250
PDMPFI-60450	450/550		200	250
PDMPFI-60500	500/600		200	250

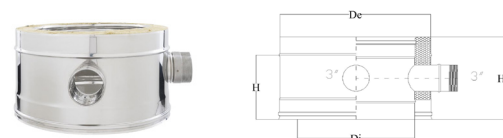

**MICTF31611 TAPPO FEMMINA FILETTATO**

COD	DIAM	CONF
MICTF31611	3"	
MICTF31611	4"	

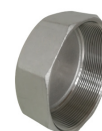

**PDAS-12 COPPIA ALETTE DI SUPPORTO**

COD	DIAM	CONF	H
PDAS-12080	80/130		230
PDAS-12100	100/150		250
PDAS-12130	130/180		280
PDAS-12150	150/200		300
PDAS-12180	180/230		330
PDAS-12200	200/250		350
PDAS-12250	250/300		400
PDAS-12300	300/350		450
PDAS-12350	350/450		550
PDAS-12400	400/500		600
PDAS-12450	450/550		650
PDAS-12500	500/600		700

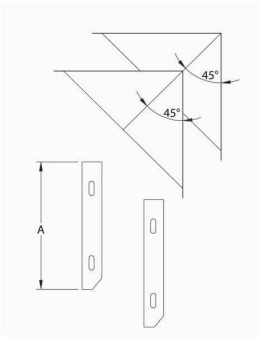
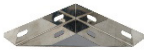

**PDPB-50 PIASTRA C/ELEMENTO DIRITTO**

COD	DIAM	CONF	H1	H2	A
PDPB-50080	80/130		96	47	230
PDPB-50100	100/150		96	47	250
PDPB-50130	130/180		96	47	280
PDPB-50150	150/200		96	47	300
PDPB-50180	180/230		96	47	330
PDPB-50200	200/250		96	47	350
PDPB-50250	250/300		96	47	400
PDPB-50300	300/350		96	47	450
PDPB-50350	350/450		96	47	550
PDPB-50400	400/500		96	47	600
PDPB-50450	450/550		96	47	650
PDPB-50500	500/600		96	47	700

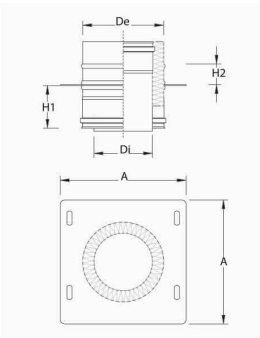

**PDPB-15 PIASTRA BASE C/SCARICO LATERALE**

COD	DIAM	CONF	H	A
PDPB-15080	80/130		100	230
PDPB-15100	100/150		100	250
PDPB-15130	130/180		100	280
PDPB-15150	150/200		100	300
PDPB-15180	180/230		100	330
PDPB-15200	200/250		100	350
PDPB-15250	250/300		100	400
PDPB-15300	300/350		100	450
PDPB-15350	350/450		100	550
PDPB-15400	400/500		100	600
PDPB-15450	450/550		100	650
PDPB-15500	500/600		100	700

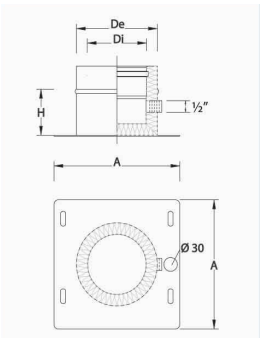

**PDGM-10 GIUNTO MONO/DOPPIA M/F**

COD	DIAM	CONF	H
PDGM-10080	80/130		195
PDGM-10100	100/150		195
PDGM-10130	130/180		195
PDGM-10150	150/200		195
PDGM-10180	180/230		195
PDGM-10200	200/250		195
PDGM-10250	250/300		195
PDGM-10300	300/350		195
PDGM-10350	350/450		195
PDGM-10400	400/500		195
PDGM-10450	450/550		195
PDGM-10500	500/600		195

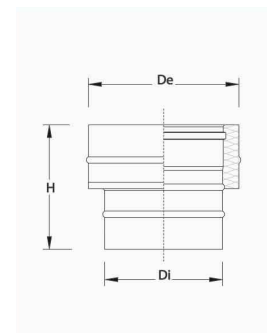

**PDRC-09 RACCORDO CALDAIA MONO/DOPPIA F/F**

COD	DIAM	CONF	H
PDRC-09080	80/130		195
PDRC-09100	100/150		195
PDRC-09130	130/180		195
PDRC-09150	150/200		195
PDRC-09180	180/230		195
PDRC-09200	200/250		195
PDRC-09250	250/300		195
PDRC-09300	300/350		195
PDRC-09350	350/450		195
PDRC-09400	400/500		195
PDRC-09450	450/550		195
PDRC-09500	500/600		195

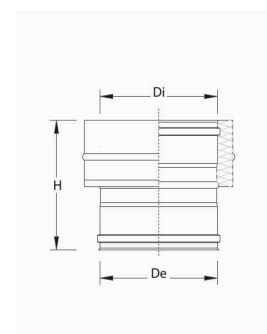

**PDGD-24 GIUNTO DOPPIA/MONO M/F**

COD	DIAM	CONF	H
PDGD-24080	80/130		195
PDGD-24100	100/150		195
PDGD-24130	130/180		195
PDGD-24150	150/200		195
PDGD-24180	180/230		195
PDGD-24200	200/250		195
PDGD-24250	250/300		195
PDGD-24300	300/350		195
PDGD-24350	350/450		195
PDGD-24400	400/500		195
PDGD-24450	450/550		195
PDGD-24500	500/600		195

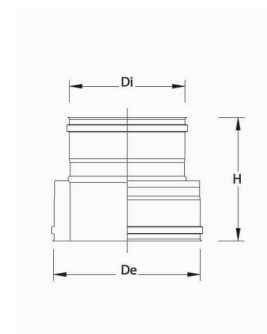

**PDRTM-01 RIDUZIONE M/F**

COD	DIAM	CONF	H	d
PDRTM-01080	80/130		193	80
PDRTM-01100	100/150		193	80
PDRTM-01130	130/180		193	80/100
PDRTM-01150	150/200		193	80/130
PDRTM-01180	180/230		193	80/150
PDRTM-01200	200/250		193	80/180
PDRTM-01250	250/300		193	80/200
PDRTM-01300	300/350		193	80/250
PDRTM-01350	350/450		193	80/300
PDRTM-01400	400/500		193	80/350
PDRTM-01450	450/550		193	80/400
PDRTM-01500	500/600		193	80/450

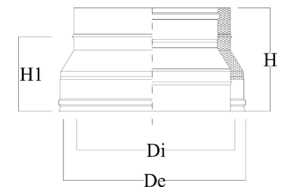

**PDRTF-01 MAGGIORAZIONE F/M**

COD	DIAM	CONF	H	d
PDRTF-01080	80/130		193	80
PDRTF-01100	100/150		193	80
PDRTF-01130	130/180		193	80/100
PDRTF-01150	150/200		193	80/130
PDRTF-01180	180/230		193	80/150
PDRTF-01200	200/250		193	80/180
PDRTF-01250	250/300		193	80/200
PDRTF-01300	300/350		193	80/250
PDRTF-01350	350/450		193	80/300
PDRTF-01400	400/500		193	80/350
PDRTF-01450	450/550		193	80/400
PDRTF-01500	500/600		193	80/450

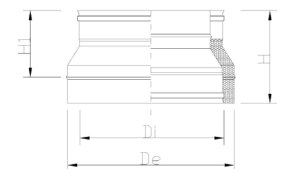

**PDCC-06 CAPPELLO CINESE**

COD	DIAM	CONF	D1
PDCC-06080	80/130		250
PDCC-06100	100/150		300
PDCC-06130	130/180		400
PDCC-06150	150/200		400
PDCC-06180	180/230		500
PDCC-06200	200/250		500
PDCC-06250	250/300		500
PDCC-06300	300/350		650
PDCC-06350	350/450		730
PDCC-06400	400/500		740
PDCC-06450	450/550		740
PDCC-06500	500/600		795

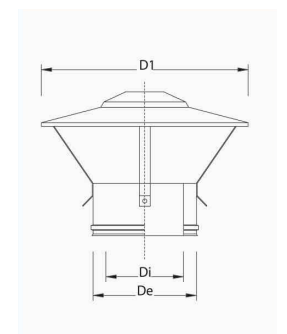

**PDAR-62      CAPPELLO ANTIRIFLUSSO**

COD	DIAM	CONF	D1
PDAR-62080	80/130		250
PDAR-62100	100/150		270
PDAR-62130	130/180		320
PDAR-62150	150/200		350
PDAR-62180	180/230		380
PDAR-62200	200/250		420
PDAR-62250	250/300		520
PDAR-62300	300/350		560
PDAR-62350	350/450		640
PDAR-62400	400/500		690
PDAR-62450	450/550		750
PDAR-62500	500/600		800

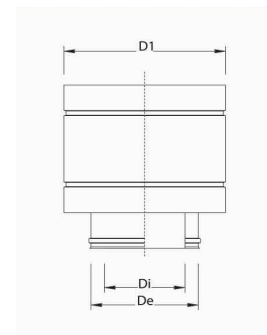

**PDCT-18      CAPPELLO TRONCO CONICO**

COD	DIAM	CONF	H
PDCT-18080	80/130		190
PDCT-18100	100/150		190
PDCT-18130	130/180		190
PDCT-18150	150/200		190
PDCT-18180	180/230		190
PDCT-18200	200/250		190
PDCT-18250	250/300		190
PDCT-18300	300/350		190
PDCT-18350	350/450		190
PDCT-18400	400/500		190
PDCT-18450	450/550		190
PDCT-18500	500/600		190

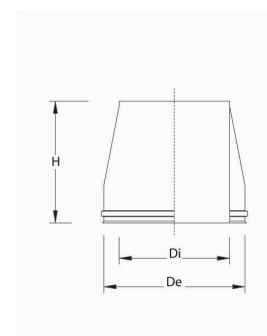

**PDCL-63      CAPPELLO LAMELLARE**

COD	DIAM	CONF	De	H
PDCL-63080	80/130		190	220
PDCL-63100	100/150		190	220
PDCL-63130	130/180		190	220
PDCL-63150	150/200		250	275
PDCL-63180	180/230		280	405
PDCL-63200	200/250		310	405
PDCL-63250	250/300		400	405
PDCL-63300	300/350		450	445

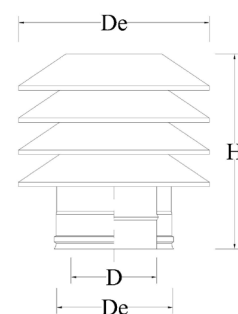

**PDCE-07 CAPPELLO EOLICO**

COD	DIAM	CONF
PDCE-07080	80/130	
PDCE-07100	100/150	
PDCE-07130	130/180	
PDCE-07150	150/200	
PDCE-07180	180/230	
PDCE-07200	200/250	
PDCE-07250	250/300	
PDCE-07300	300/350	

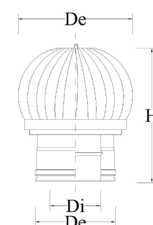

**PDFI-20 FALDALE PER TETTI INCLINATI**

COD	DIAM	CONF	D1	A	H
PDFI-20080	80/130		160	625	175
PDFI-20100	100/150		180	625	175
PDFI-20130	130/180		210	625	175
PDFI-20150	150/200		230	750	175
PDFI-20180	180/230		260	750	175
PDFI-20200	200/250		280	750	190
PDFI-20250	250/300		330	850	190
PDFI-20300	300/350		380	850	200
PDFI-20350	350/450		480	950	200
PDFI-20400	400/500		530	950	200
PDFI-20450	450/550		580	1050	250
PDFI-20500	500/600		630	1050	250

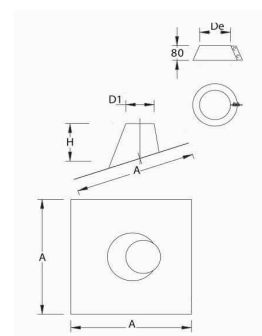

**PDFP-23 FALDALE PER TETTI PIANI**

COD	DIAM	CONF	D1	A	H
PDFP-23080	80/130		160	625	175
PDFP-23100	100/150		180	625	175
PDFP-23130	130/180		210	625	175
PDFP-23150	150/200		230	750	175
PDFP-23180	180/230		260	750	175
PDFP-23200	200/250		280	750	190
PDFP-23250	250/300		330	850	190
PDFP-23300	300/350		380	850	200
PDFP-23350	350/450		480	950	200
PDFP-23400	400/500		530	950	200
PDFP-23450	450/550		580	1050	250
PDFP-23500	500/600		630	1050	250

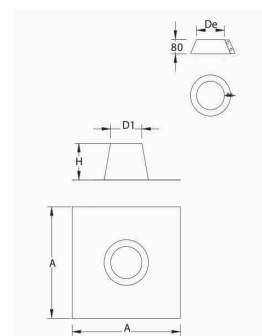

**PDFIP-21 FALDALE TETTI INCLINATI C/PIOMBO**

COD	DIAM	CONF	D1	A	H
PDFIP-21080	80/130		160	625	175
PDFIP-21100	100/150		180	625	175
PDFIP-21130	130/180		210	625	175
PDFIP-21150	150/200		230	750	175
PDFIP-21180	180/230		260	750	175
PDFIP-21200	200/250		280	750	190
PDFIP-21250	250/300		330	850	190
PDFIP-21300	300/350		380	850	200
PDFIP-21350	350/400				
PDFIP-21400	400/500				

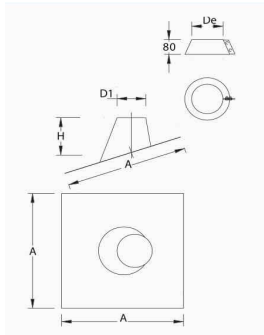

**PDSCOSS SCOSSALINA PER FALDALI**

COD	DIAM	CONF	H	D. MAGGIORE
PDSCOSS080	80/130		100	230
PDSCOSS100	100/150		100	250
PDSCOSS130	130/180		100	280
PDSCOSS150	150/200		100	300
PDSCOSS180	180/230		100	330
PDSCOSS200	200/250		100	350
PDSCOSS250	250/300		100	400
PDSCOSS300	300/350		100	450
PDSCOSS350	350/450		100	550
PDSCOSS400	400/500		100	600
PDSCOSS450	450/550		100	650
PDSCOSS500	500/600		100	700

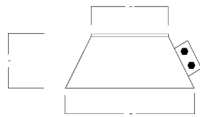

**PDFT-17 FASCETTA PER CAVI TIRANTI**

COD	DIAM	CONF	H
PDFT-17080	80/130		80
PDFT-17100	100/150		80
PDFT-17130	130/180		80
PDFT-17150	150/200		80
PDFT-17180	180/230		80
PDFT-17200	200/250		80
PDFT-17250	250/300		80
PDFT-17300	300/350		80
PDFT-17350	350/450		80
PDFT-17400	400/500		80
PDFT-17450	450/550		80
PDFT-17500	500/600		80

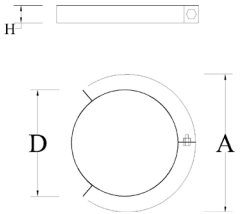

**PDFB-19 FASCETTA DI BLOCCAGGIO**

COD	DIAM	CONF	H
PDFB-19080	80/130		40
PDFB-19100	100/150		40
PDFB-19130	130/180		40
PDFB-19150	150/200		40
PDFB-19180	180/230		40
PDFB-19200	200/250		40
PDFB-19250	250/300		40
PDFB-19300	300/350		40
PDFB-19350	350/450		40
PDFB-19400	400/500		40
PDFB-19450	450/550		40
PDFB-19500	500/600		40
PDFB-19550	550/650		40
PDFB-19600	600/700		40

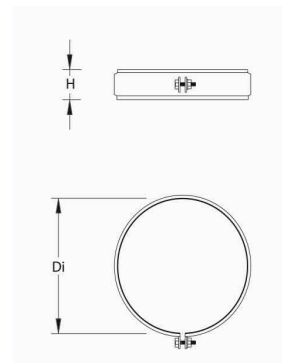

**TAPMI42 TAPPO ISPEZIONE**

COD	DIAM	CONF
TAPMI42-080	80/130	
TAPMI42-100	100/150	
TAPMI42-130	130/180	
TAPMI42-150	150/200	
TAPMI42-200	180/230	

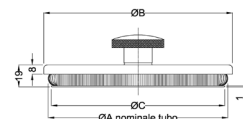

**PDFM-14 FASCETTA MURALE REGOLABILE**

COD	DIAM	CONF	A
PDFM-14080	80/130		141
PDFM-14100	100/150		156
PDFM-14130	130/180		176
PDFM-14150	150/200		193
PDFM-14180	180/230		215
PDFM-14200	200/250		228
PDFM-14250	250/300		264
PDFM-14300	300/350		300
PDFM-14350	350/450		371
PDFM-14400	400/500		406
PDFM-14450	450/550		442
PDFM-14500	500/600		476

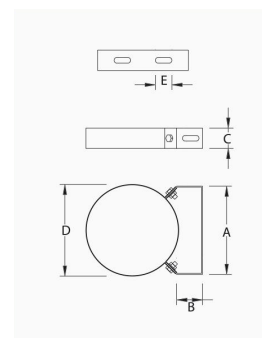

**PROLUNGAPS105 PROLUNGA FASCETTA MURALE INOX L.105**

COD	DIAM	CONF	L.
PROLUNGAPS105	TUTTI		105



**PROLUNGAPS205 PROLUNGA FASCETTA MURALE INOX L.205**

COD	DIAM	CONF	L.
PROLUNGAPS205	TUTTI		205



**PSGT-70 GUARNIZIONE**

COD	DIAM	CONF
PSGT-70080	80	50
PSGT-70100	100	50
PSGT-70130	130	10
PSGT-70150	150	10
PSGT-70180	180	10
PSGT-70200	200	10
PSGT-70250	250	10
PSGT-70300	300	10
PSGT-70350	350	10
PSGT-70400	400	10



**SPIIA SPORTELLO CAMERA PICCOLO**

COD	DIAM	CONF	MISURE INT.	MISURE EST.
SPIIA	VARI		77X136	113X189



**SPGRA SPORTELLO CAMERA GRANDE**

COD	DIAM	CONF	MISURE INT.	MISURE EST.
SPGRA	VARI		115X210	190X282

